

NOTE: Our products' specifications are always improving, please forgive us if there is any change without special notice.
Photographing or printing will cause color difference, please make the subject as standard.



PUMPMAN

INDUSTRIAL PUMP CATALOGUE

50HZ

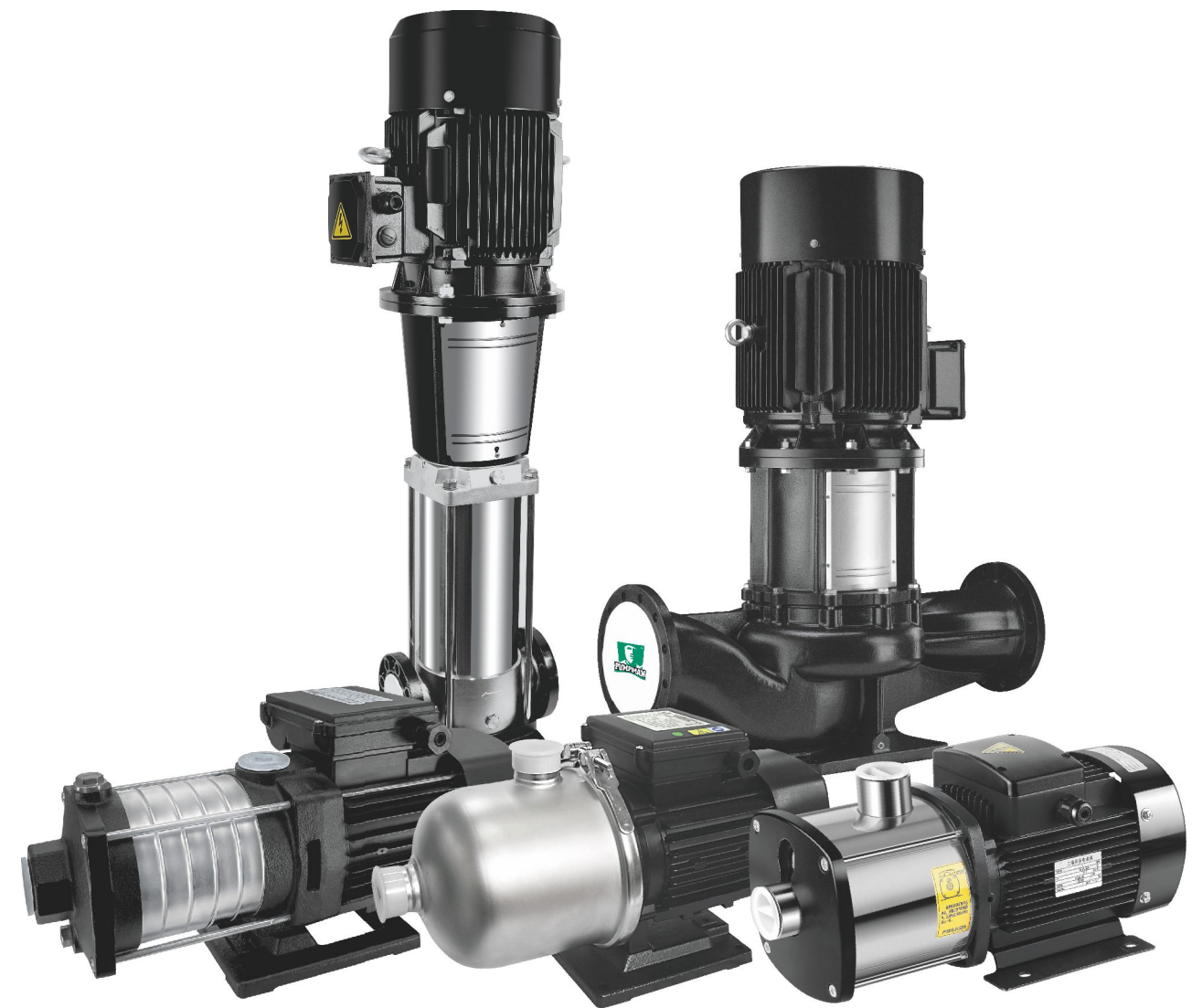

ZHEJIANG TAIFU PUMP CO.,LTD

Add: 5, Longmen Road, East Industry Center, Wenling, Zhejiang, China P.C: 317511

Tel: 0086-576-8631 2865

E-mail: chen@chinataifu.com



COMPANY PROFILE



Listed Company



Full Range



Whole Industrial Chain



- History: More than 40 years experience of manufacturing pumps since 1982
- Scale: Cover an area of up to 170000 Square meters , have nearly 1000 employees
- Technology: A group of professional technical engineers and a strong R&D team
- Management: Scientific ERP management and strict quality control system
- Equipments: Japanese automatic molding machine & pouring machine for cast iron parts, double spindle lathe for pump body and stator, Japanese CNC precision automatic lathe for shaft, automatic wiring machine, electrophoresis, etc.
- Innovations: Continuously diversify products range to satisfy customers' demands
- Production capacity: 200,000 pcs/month
- Marketing network: America, Europe, Asia, Africa, etc;
- Long-term supplier of world-class companies: GAZI and main supermarkets in USA etc;
- NEW: Professional technology development and production group for controller PCB board

RoHS TÜV CE ISO9001 ISO14001 ISO45001



FRAMEWORK OF SIX BUSINESS UNITS



40⁺
40 years
of pump industry

4
Russia, Vietnam, North
America, Indonesia

150⁺
More than 150 export
countries

700⁺
More than 700 types and
models of water pumps

LEADING TECHNOLOGY AND PRODUCTION PROCESS

Build core power of competitiveness
Enhance added value of innovation

80⁺
R & D Personnel

The company following a quality first path by strictly implementing the theory of "Market oriented, innovation, quality and customer satisfaction" to get a lot of certificates, such as ISO9001 (Quality Management System), ISO14001 (Environmental Management System), ISO45001:2018(Occupational Health and Safety Management System) as well as CE, CSA certificates and so on in order to adapt the demand of national markets.

86⁺
National Patent

It has an international and systematic R & D team led by doctors and senior engineers, implements a talent training mechanism of "introducing and going out", combines production, learning and research with universities and colleges in Zhejiang University, and carries out research on new energy, new materials and new technologies.



CHL/CHLF(T)/CHM

Stainless Steel Horizontal Multistage Centrifugal Pump

Technical Parameters

Flow rate: 0,56-28m³/h

Head range: 7-60m

Power range: 0,37-4,4kW

Application

Air conditioning system

Cooling system

Industrial cleaning

Water treatment (purification of water)

Aquaculture

Fertilization/metering system

Environmental applications

(Other) Many specialized and specific purposes

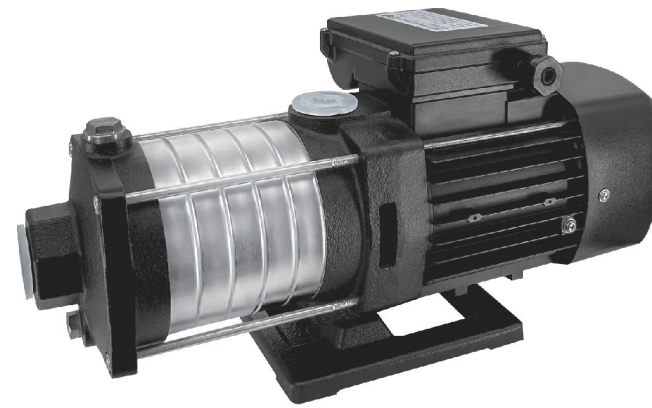

Performance Range

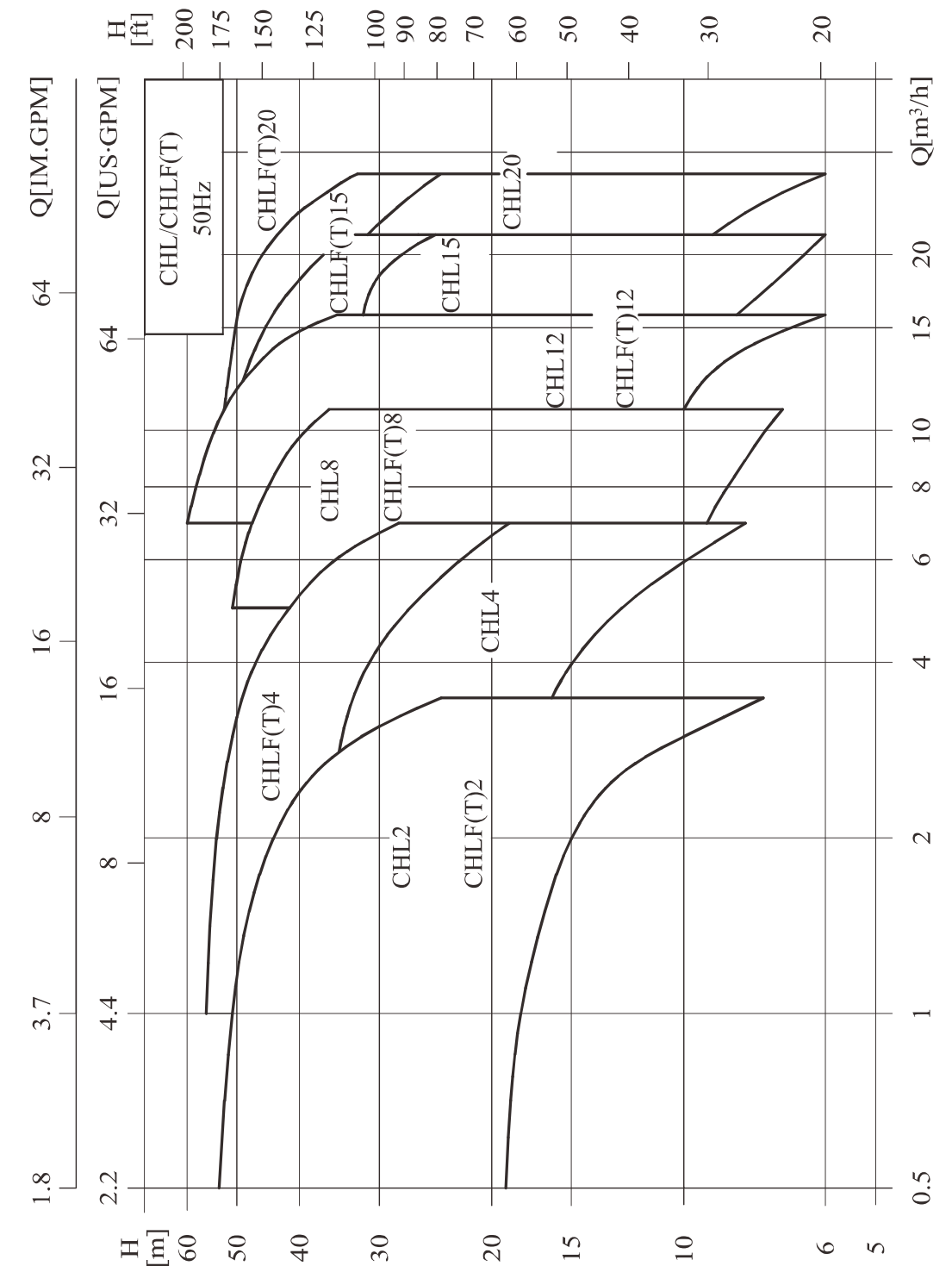

● Application

The CHL and CHLF (T) pumps are mainly used in industry:

- Air conditioning system
- Cooling system
- Industrial cleaning
- Water treatment (purification of water)
- Aquaculture
- Fertilization/metering system
- Environmental applications
- (Other) Many specialized and specific purposes

● Operating Conditions

- Liquid temperature:
room temperature type -15°C to +70°C
hot water type -15°C to +105°C
- Maximum ambient temperature: +40
- Maximum operating pressure: 10 bar
- The maximum inlet pressure is limited by the maximum operating pressure.

● Conveying Liquids

- A thin, clean, non flammable and explosive liquid that does not contain solid particles or fibers. Pumps can transport light chemical media such as mineral water, softened water, pure water, clear oil, and others.
- When the density or viscosity of the conveyed liquid is greater than that of water, a high-power motor must be used if necessary.
- The suitability of a pump for a specific liquid is determined by various factors, the most important of which are chlorine content, pH value, temperature and solvent, oil content, etc.

● Definition of Model

CHL Example

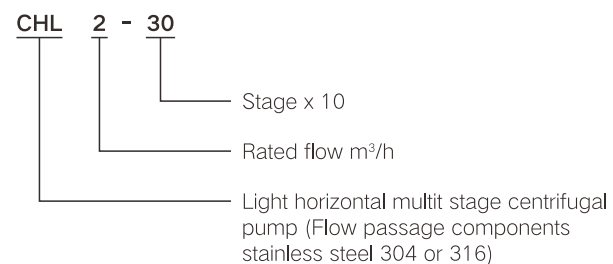

CHLF(T) Example

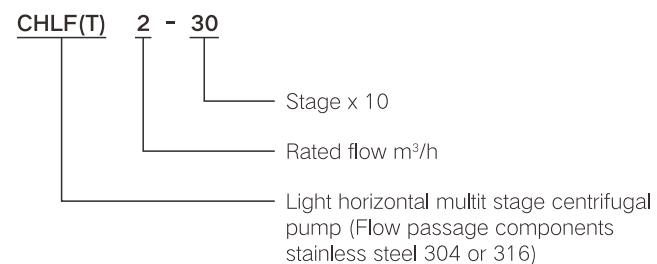

● Motor

- The motor is a fully enclosed, air-cooled two pole motor.
- Protection level: IP55
- Insulation level: F
- Standard voltage: 50Hz: 1x220-240V
- The maximum power of a 3x220-240V/380-415V single-phase motor is 2.4kw.

● Pump

- Horizontal multi-stage non self priming centrifugal pump with extended shaft motor.
- The compact structure makes the pump size very small, with axial inlet and radial outlet.

● Curve Conditions

- The following conditions apply to the performance curve shown later.
- All curves are based on the measured values of the motor at a constant speed of 2900rpm.
- Curve tolerance in accordance with ISO9906:2012, Grade 3B.
- The test uses 20C air free water with a kinematic viscosity of 1mm²/s.
- The use of pumps should refer to the performance range of the bold curve to prevent overheating caused by low flow or motor overload caused by excessive flow.

● Cross Section View CHL2,4

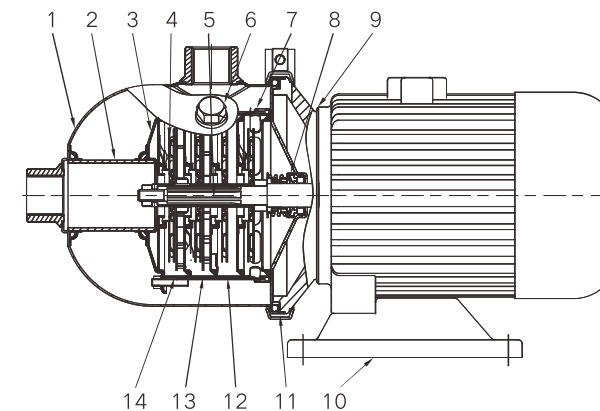

● Material CHL2,4

NO.	Parts	Material	AISI/ASTM
1	Inlet and Outlet Section	Stainless Steel	AISI304
2	Connecting Pipe	Stainless Steel	AISI304
3	Pressing Plate	Stainless Steel	AISI304
4	Impeller	Stainless Steel	AISI304
5	Axis	Stainless Steel	AISI304
6	Plug	Stainless Steel	AISI304
7	Outlet Guide Vane	Stainless Steel	AISI304
8	Mechanical Seal		
9	Motor End Cover	Aluminium Alloy	
10	Base	Steel Plate	AISI1015
11	Quick Coupling	Stainless Steel	AISI304
12	Guide Vane	Stainless Steel	AISI304
13	Support Guide Vane	Stainless Steel	AISI304
14	Deflector	Stainless Steel	AISI304

● Cross Section View CHL8,12,15,20

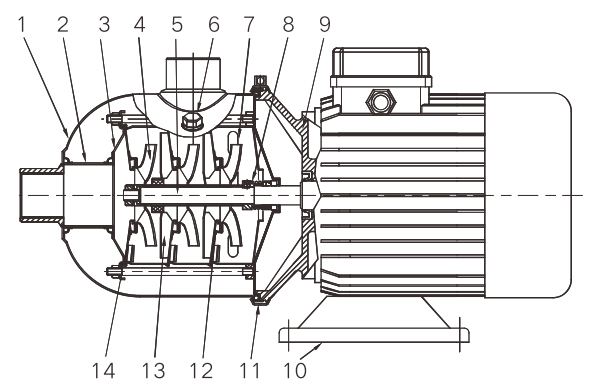

● Material CHL8,12,15,20

NO.	Parts	Material	AISI/ASTM
2	Plug	Stainless Steel	AISI304
3	Bearing	Tungsten Carbide	
4	Axis	Stainless Steel	AISI304
5	Impeller	Stainless Steel	AISI304
8	Mechanical Seal		
9	Motor End Cover	Aluminium Alloy	
10	Base	Steel Plate	AISI1015
11	Tie Rod	Stainless Steel	AISI304
12	Guide Vane	Stainless Steel	AISI304
13	Support Guide Vane	Stainless Steel	AISI304
14	Impeller Spacer	Stainless Steel	AISI304
CHLF			
1	Water Inlet	Stainless Steel	AISI304
7	Outlet Water Body	Stainless Steel	AISI304
CHLF(T)			
1	Water Inlet	Cast Iron	ASTM25B
7	Outlet Water Body	Cast Iron	ASTM25B

CHL

Stainless Steel Horizontal Multistage Centrifugal Pump

Technical Parameters

Flow rate: 1-28m³/h

Head range: 7-60m

Power range: 0,37-4,4kW

Application

Air conditioning system

Cooling system

Industrial cleaning

Water treatment (purification of water)

Aquaculture

Fertilization/metering system

Environmental applications

(Other) Many specialized and specific purposes



● Performance Curve

2900rpm

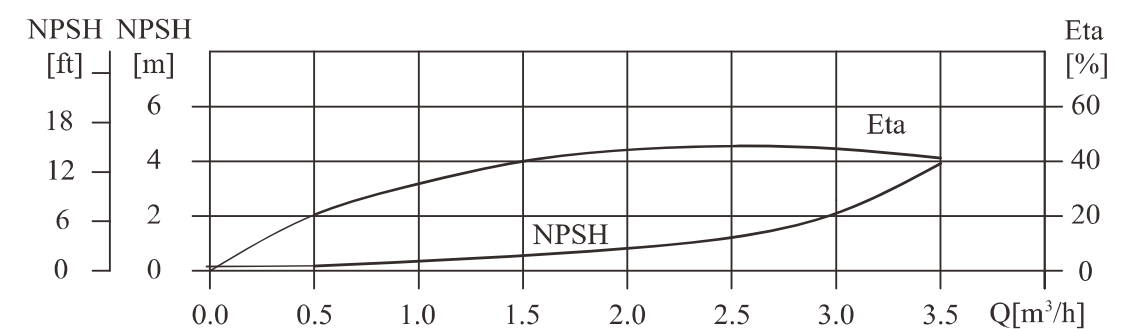
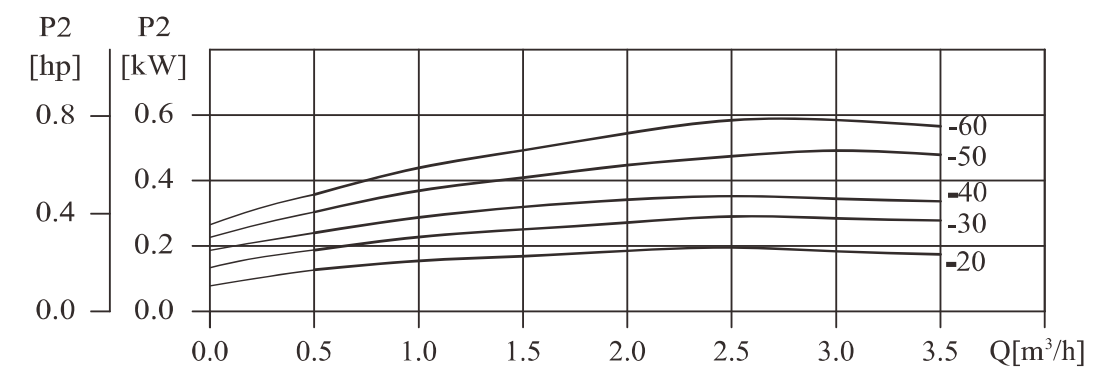
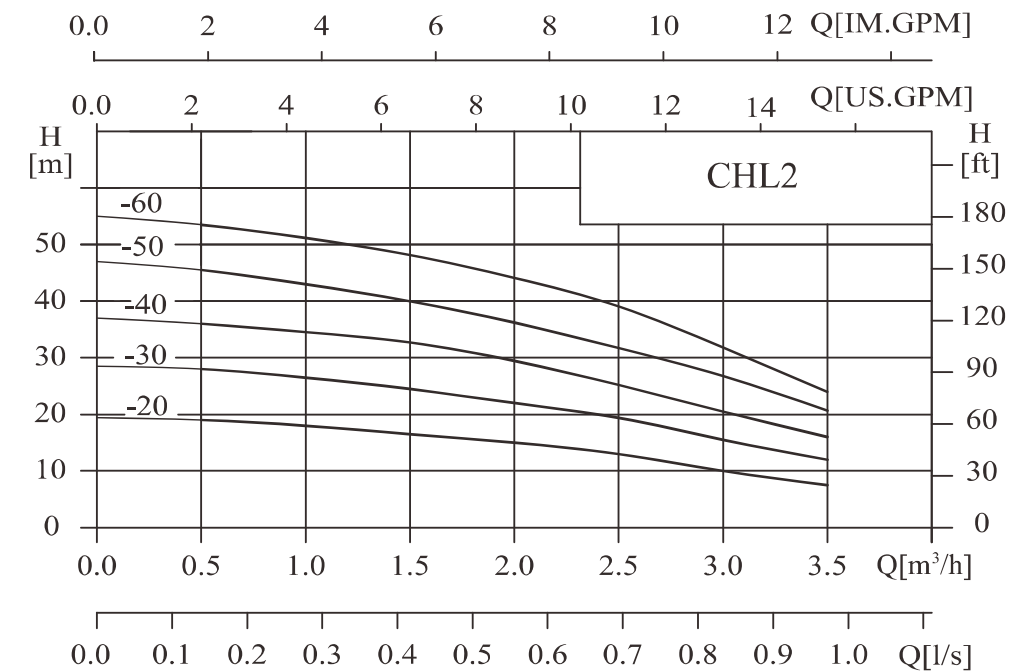

● Performance Table

Model	Power (kW)	Q (m³/h)	0.5	1	1.5	2.0	2.5	3.0	3.5
CHL2-20	0.37	H(m)	19	18	16.5	15	13	10	7.5
CHL2-30	0.37		28	26.5	24.5	22	19	15.5	12
CHL2-40	0.55		36	34.5	33	29	25	20.5	16
CHL2-50	0.55		45.5	43	40	36	31.5	26.5	20.5
CHL2-60	0.75		53.5	51	48	44	39	32	24

● Installation Sketch

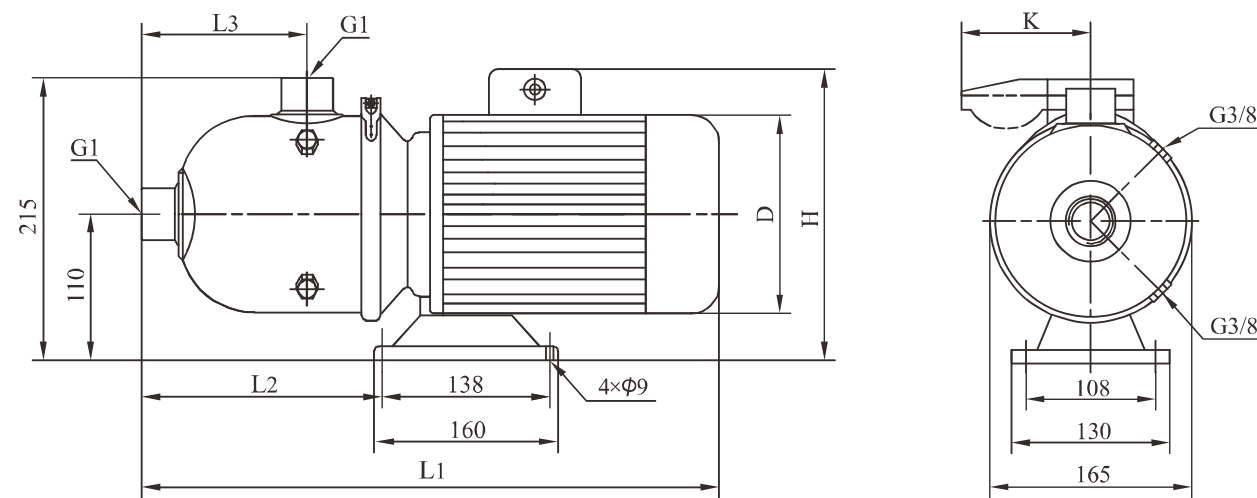

● Size and Weight

Motor(kW)	Model	Dimensions(mm)						Weight (kg)
		L1	L2	L3	D	H	K	
Three phase/ single phase	CHL2-20	400	165	125	141	215/249	62	10
	CHL2-30	400	165	125	141	215/249	62	10
	CHL2-40	400	165	125	141	215/249	62	11
	CHL2-50	400	165	125	141	215/249	62	12
	CHL2-60	420	165	125	151/161	225/265	91	14

● Performance Curve

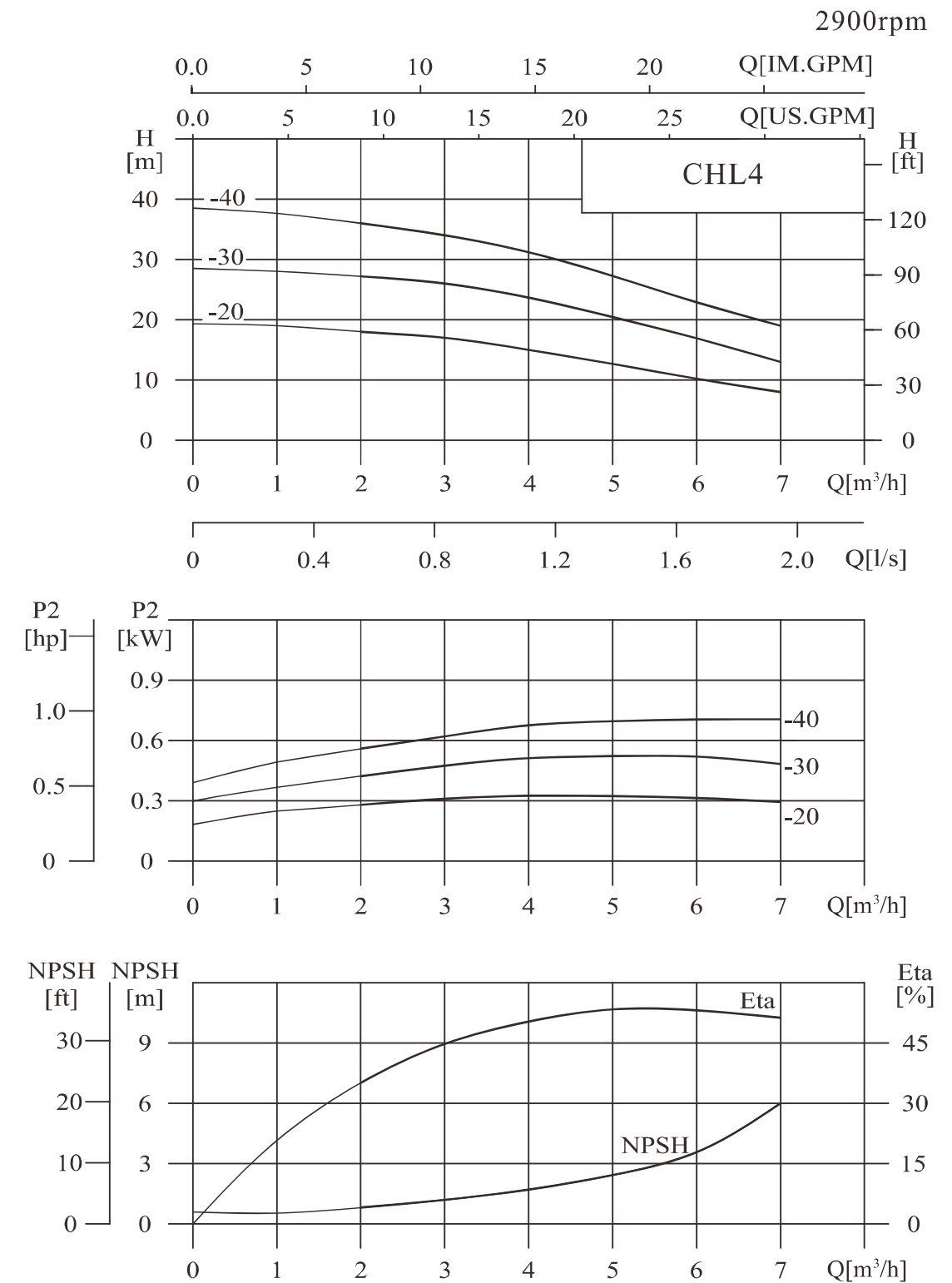

● Performance Table

Model	Power (kW)	Q (m³/h)	1	2	3	4	5	6	7
CHL4-20	0.37	H(m)	19	18	17	15	12.5	10	8
CHL4-30	0.55		28	27	26	23.5	20.5	17	13
CHL4-40	0.75		37.5	36	34	31	27	23	19

● Installation Sketch

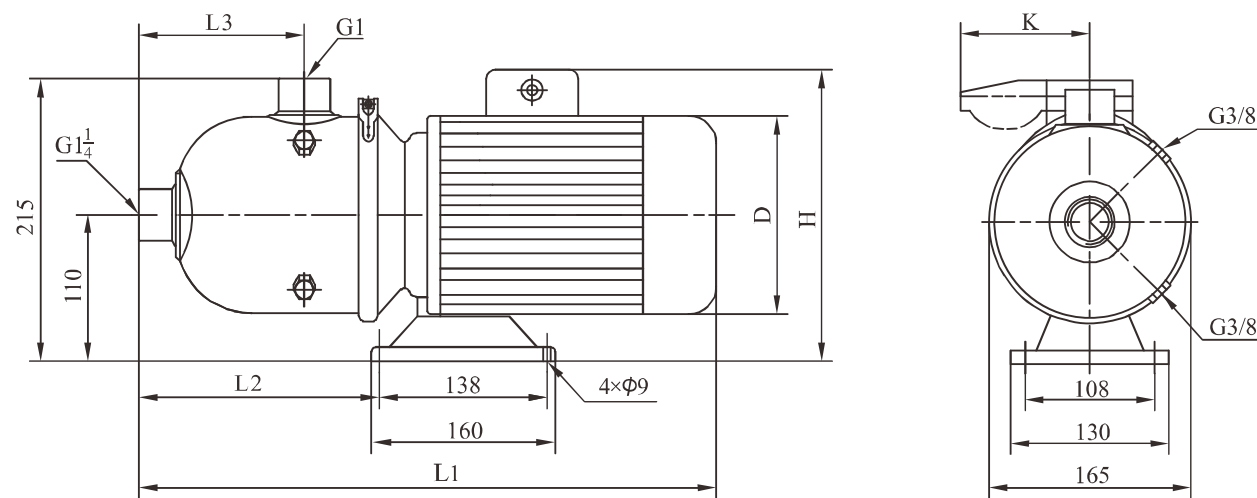

● Size and Weight

Motor(kW)	Model	Dimensions(mm)						Weight (kg)
		L1	L2	L3	D	H	K	
Three phase/ single phase	CHL4-20	400	172	132	141	215/249	62	10
	CHL4-30	400	172	132	141	215/249	62	11
	CHL4-40	420	172	132	151/161	225/265	91	14

● Performance Curve

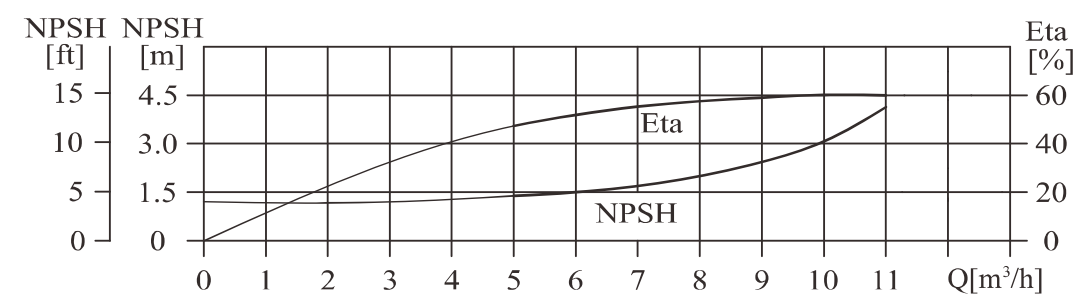
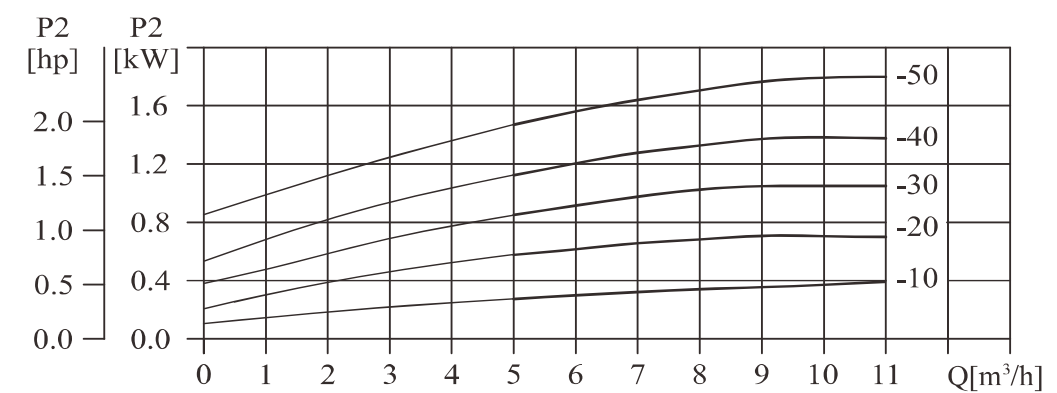
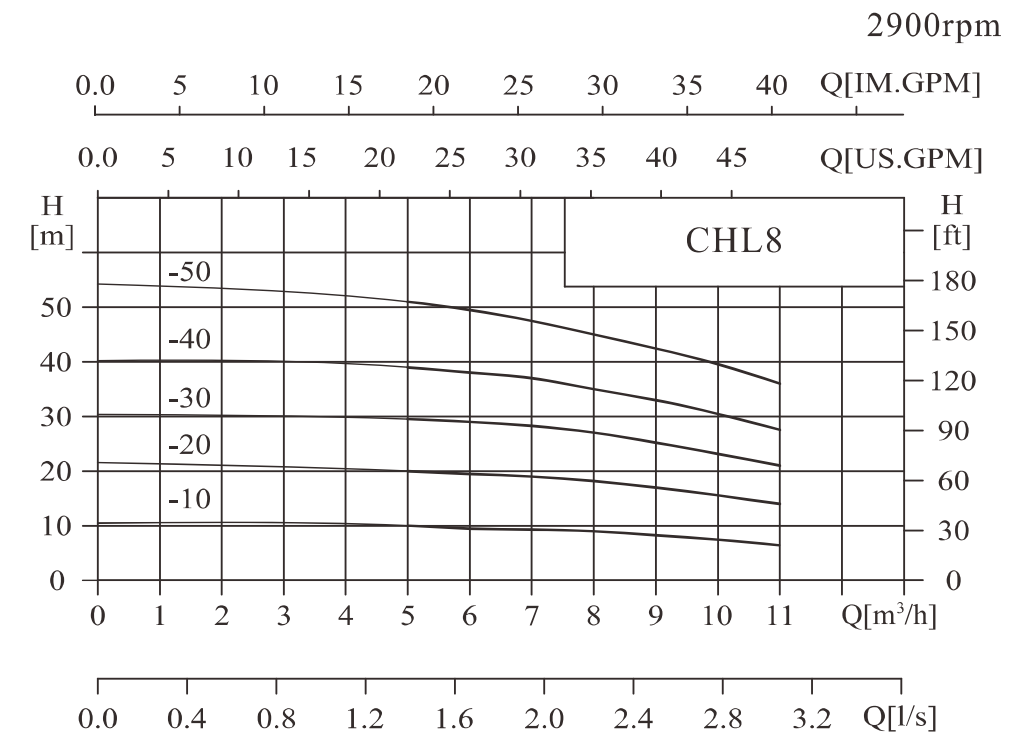

● Performance Table

Model	Power (kW)	Q (m³/h)	5	6	7	8	9	10	11
CHL8-10	0.75	H(m)	10	9.5	9.3	9	8	7.5	7
CHL8-20	0.75		20	19.5	19	18	17	15.5	14
CHL8-30	1.1		29.5	29	28	27	25	23	21
CHL8-40	1.5		39	38	37	35	33	30.5	27.5
CHL8-50	2.2		51	49.5	47.5	45	42.5	39.5	36

● Installation Sketch

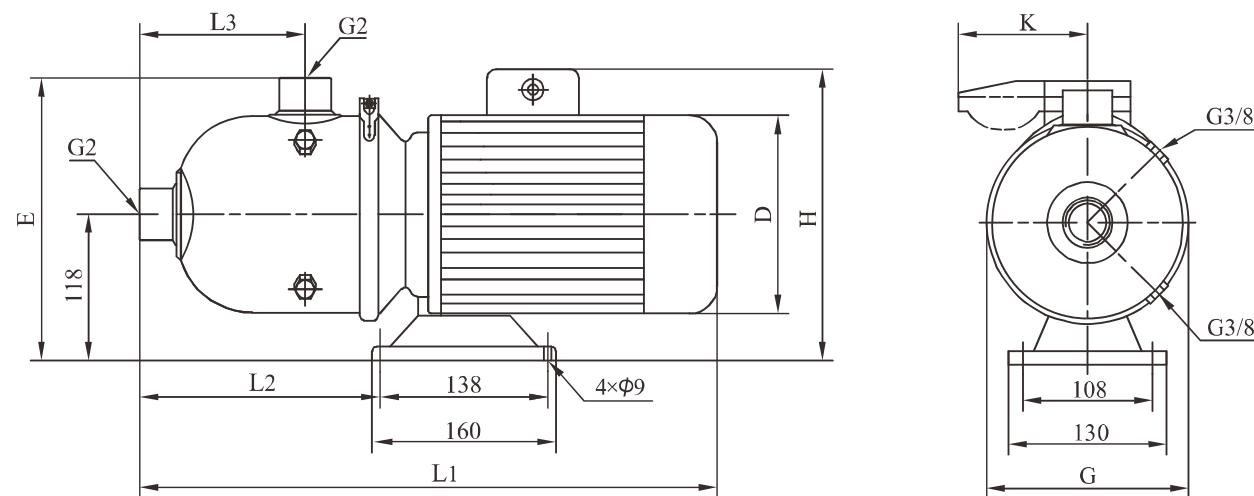

● Size and Weight

Motor(kW)	Model	Dimensions(mm)								Weight (kg)
		L1	L2	L3	E	G	D	H	K	
Three phase/ single phase	CHL8-10	530	279	176	264	223	151/161	225/265	91	18
	CHL8-20	530	279	176	264	223	151/161	225/265	91	19
	CHL8-30	530	279	176	264	223	151/161	230/265	91	22
	CHL8-40	563	279	176	265	223	171/176	235/270	91	27
	CHL8-50	563	279	176	265	223	171/176	235/270	91	32

● Performance Curve

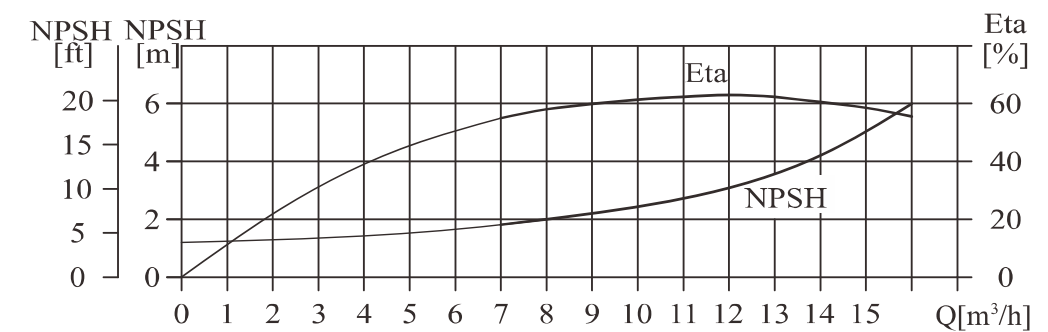
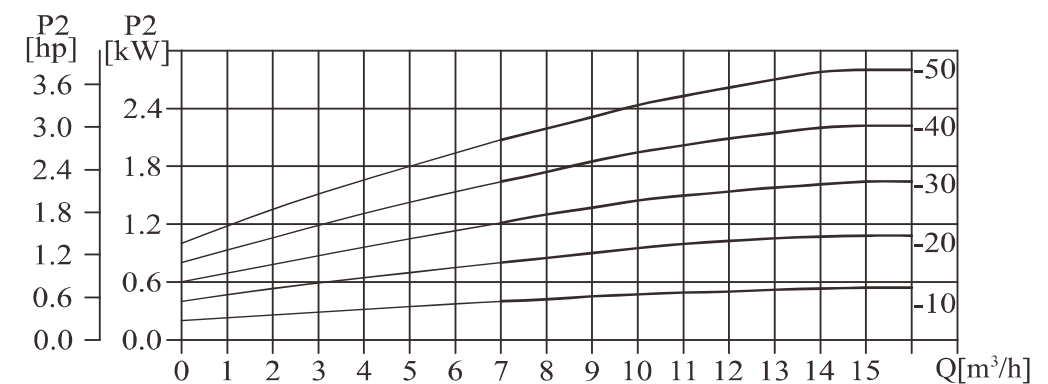
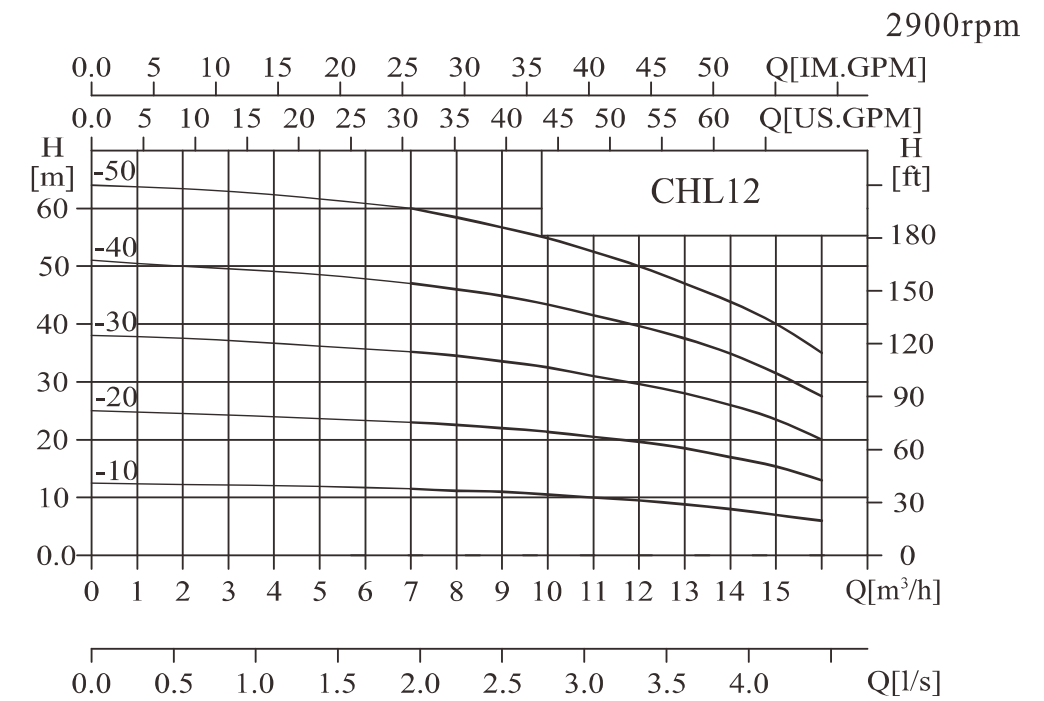

● Performance Table

Model	Power (kW)	Q (m³/h)	7	8	9	10	11	12	13	14	15	16
CHL12-10	0.75	H(m)	11.5	11.2	11	10.5	10	9.5	9	8	7	6
CHL12-20	1.2		23	22.5	22	21.5	20.5	19.5	18.5	17	15.5	13
CHL12-30	1.8		35	34.5	33.5	32.5	31	29.5	28	26	23.5	20
CHL12-40	2.4		47	46	45	43.5	41.5	39.5	37.5	35	31.5	27.5
CHL12-50	3		60	58	56.5	55	52.5	50	47	44	40	35

● Installation Sketch

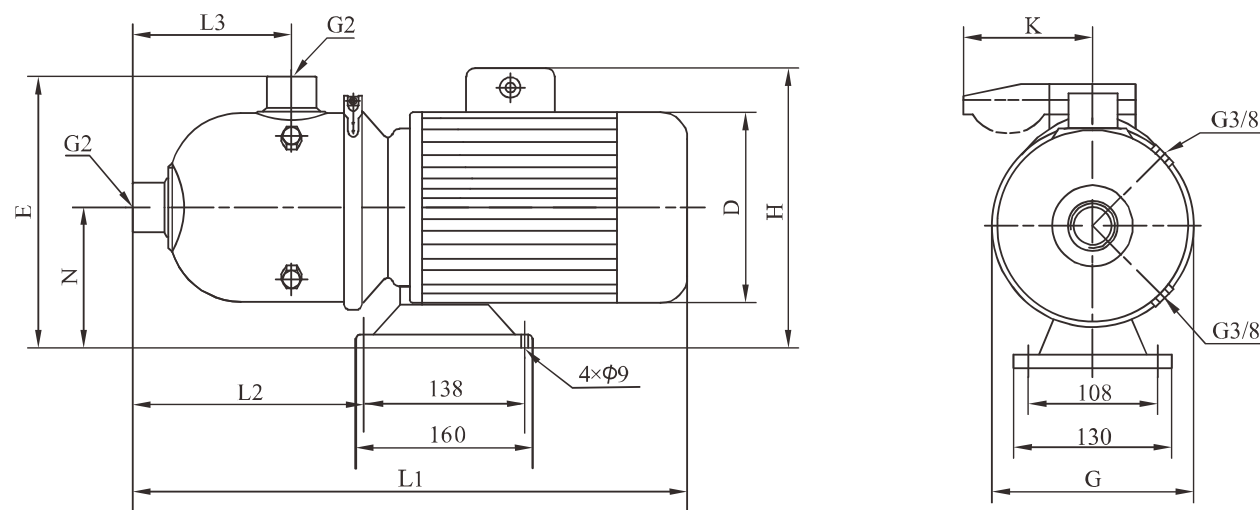

● Size and Weight

Motor(kW)	Model	Dimensions(mm)									Weight (kg)
		L1	L2	L3	N	E	G	D	H	K	
Three phase/ single phase	CHL12-10	530	279	176	117	264	223	151/161	225/265	91	18
	CHL12-20	530	279	176	117	264	223	151/161	225/265	91	22
	CHL12-30	563	279	176	118	265	223	171/176	235/270	91	28
	CHL12-40	563	279	176	118	265	223	171/176	235/270	91	33
	CHL12-50	610	279	176	128	275	223	196	259		37

● Performance Curve

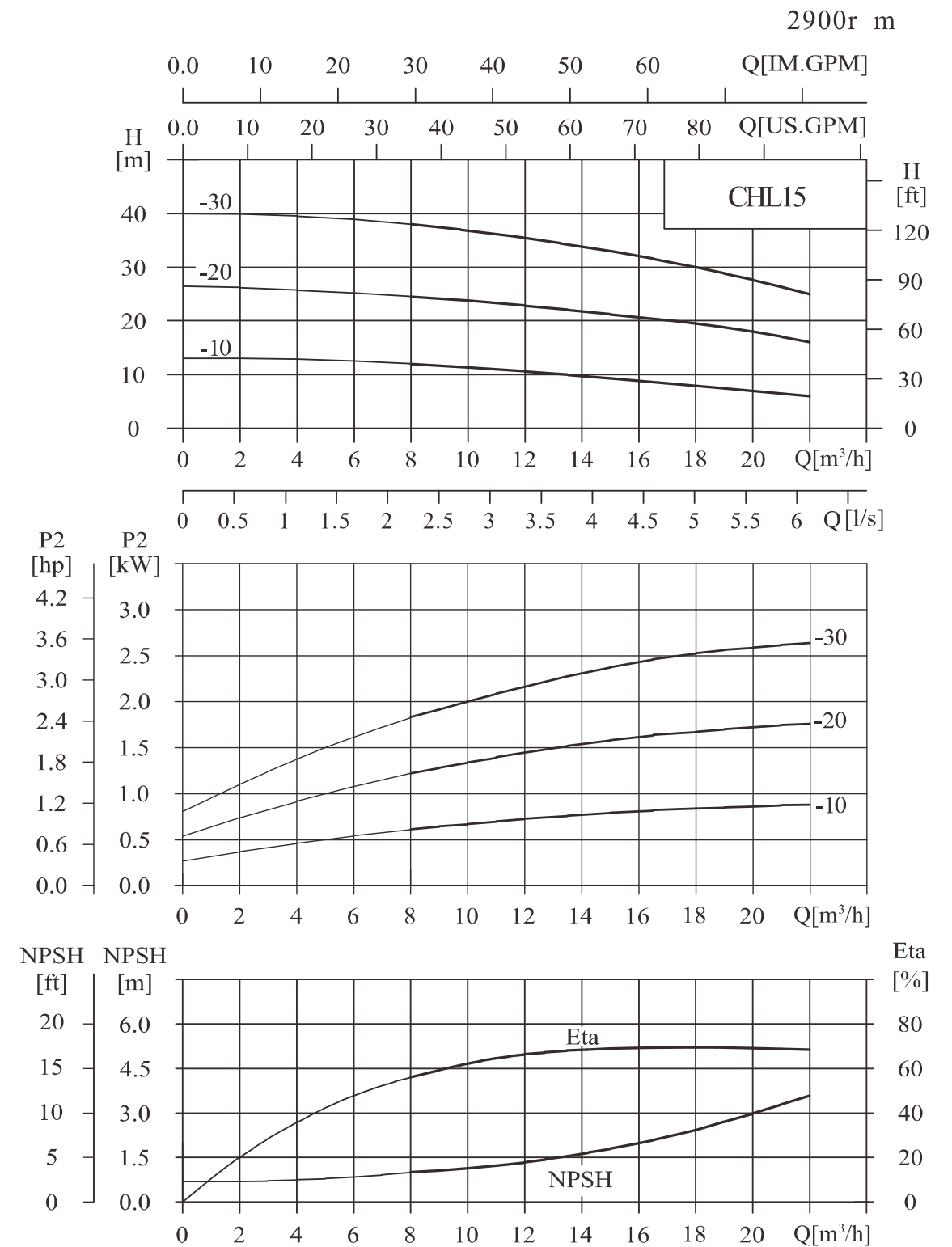

● Performance Table

Model	Power (kW)	Q (m ³ /h)	8	10	12	14	15	16	18	20	22
CHL15-10	1.1	H(m)	12	11	10.5	9.5	9	8.5	7.5	6.5	6
CHL15-20	2.2		24,5	24	23	22	21	20,5	19	18	16
CHL15-30	3		38	37	35,5	34	33	32	30	28	25

● Installation Sketch

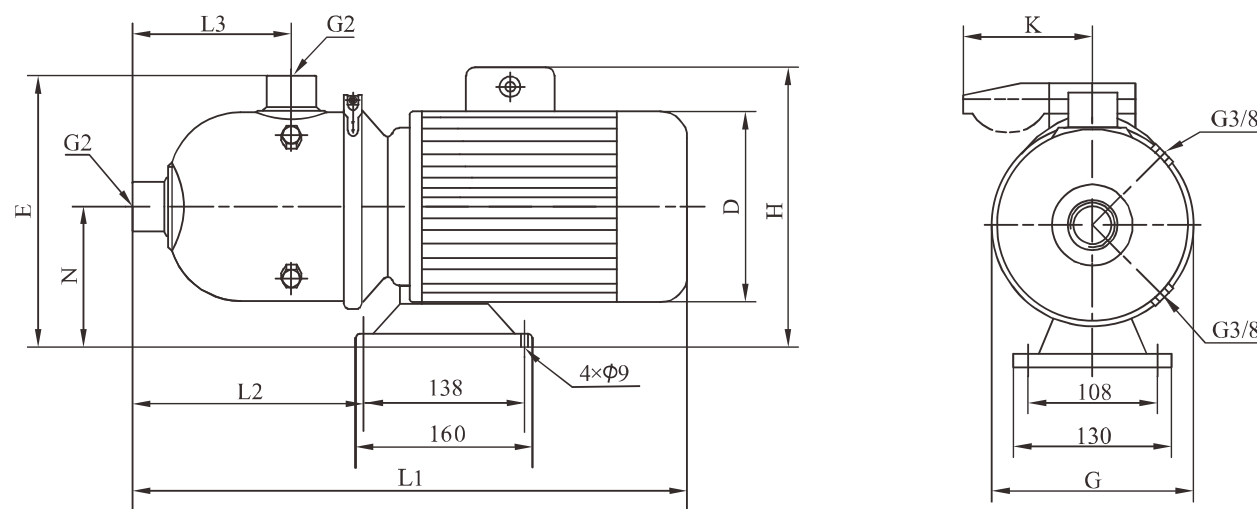

● Size and Weight

Motor(kW)	Model	Dimensions(mm)									Weight (kg)
		L1	L2	L3	N	E	G	D	H	K	
Three phase/ single phase	CHL15-10	530	279	176	117	264	223	151/161	225/265	91	20
	CHL15-20	563	279	176	118	265	223	171/176	235/270	91	26
	CHL15-30	605	279	176	128	275	223	196	259		34

● Performance Curve

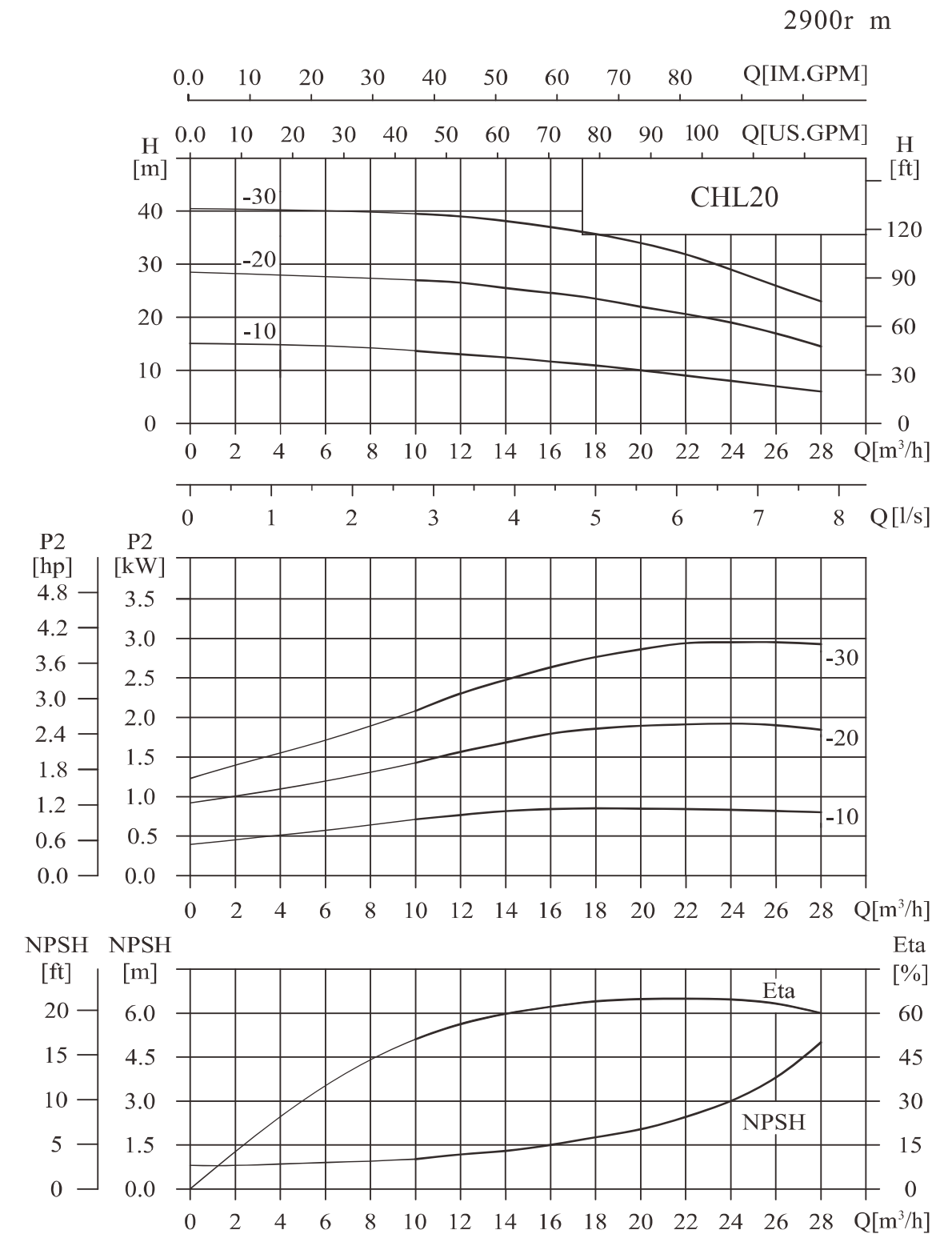

TECHNICAL DATA

● Performance Table

Model	Power (kW)	Q (m ³ /h)	10	12	14	16	18	20	22	24	26	28
CHL20-10	1.1	H(m)	13.5	13	12.5	12	11	10	9	8	7	6
CHL20-20	2.2		27	26.5	25.5	25	23.5	22	20.5	18.5	17	14.5
CHL20-30	4		39.5	39	38	37.5	35.5	34	31.5	29	26	23

● Installation Sketch

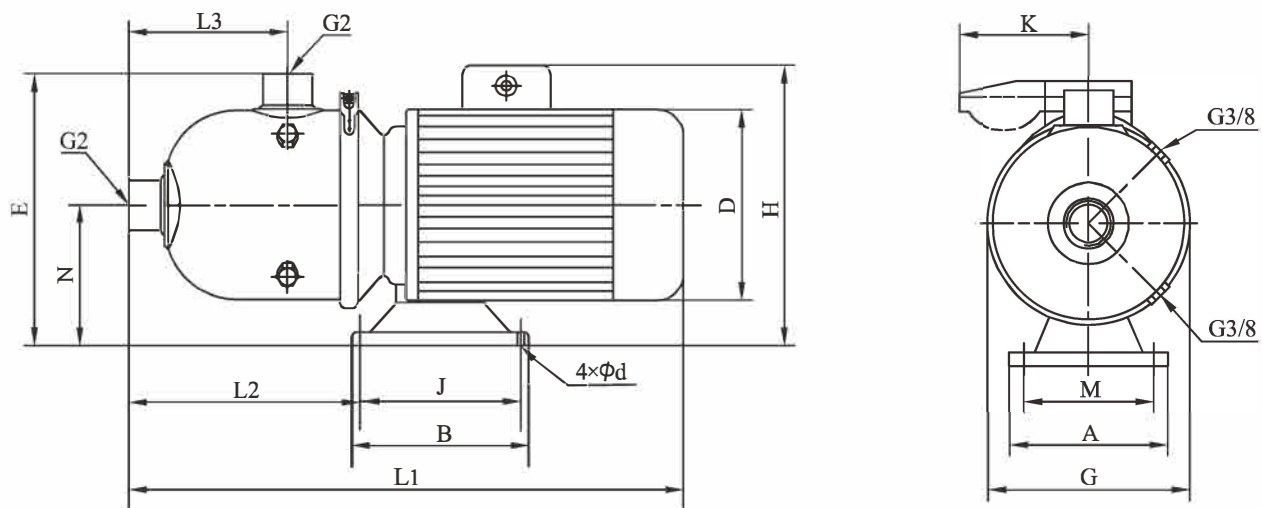

● Size and Weight

Motor(kW)	Model	Dimensions(mm)														Weight (kg)
		L1	L2	L3	N	E	G	A	M	B	J	d	D	H	K	
Three phase/ single phase	CHL20-10	530	279	176	117	264	223	130	108	160	138	9	151/161	230/265	91	20
	CHL20-20	563	279	176	118	265	223	130	108	160	138	9	171/176	235/270	91	26
	CHL20-30	612	357	176	120	267	223	220	190	170	140	12	213	270		40